



Features

- ★ Renyx cover with heat sink
- ★ DC control ,AC or DC output SSR in an Industry standard EMR plug in package
- ★ Ratings of 5A and 10A
- ★ Load voltage of 5-60VDC,5-80VDC and 24-280VAC
- ★ LED input status indicator
- ★ Mechanical life semipermanent
- ★ Small size and low power



Specification

ZQ type

Q SSR B -K8 -6 05 DD

Plug-in type solid state relay

Design code

Module number 4 8 10

Output voltage 3:24-280VAC,6:5-60VDC,10:5-80VDC

Output current 5A 10A

DA:DC control AC
DD:DC control DC

Technical Parameter

Control Voltage	12:5-15VDC, 24:12-32VDC	
Control Current	6-35mA	
Make-on Voltage	5VDC, 12VDC	
Break-off Voltage	1.3VDC,2VDC	
Load Voltage	3:24-280VAC	6:5-60VDC,10:5-80VDC
Load Current	5A,10A	
Instant Voltage	3:600VAC	6:60VDC, 10:80VDC
Voltage Drop in On	< 1.6VAC	< 1.2VDC
On-off Time	≤10mS	≤5mS
Leakage Current in off	≤10mA	≤5mA
Dielectric Strength	≥1500VAC	
Insulation Resistance	500MΩ	
Ambient Temp	-30°C ~ +80°C	
Outline size	...X83X56	
Installation	Din-rail mount	



Outline mounting view(mm)

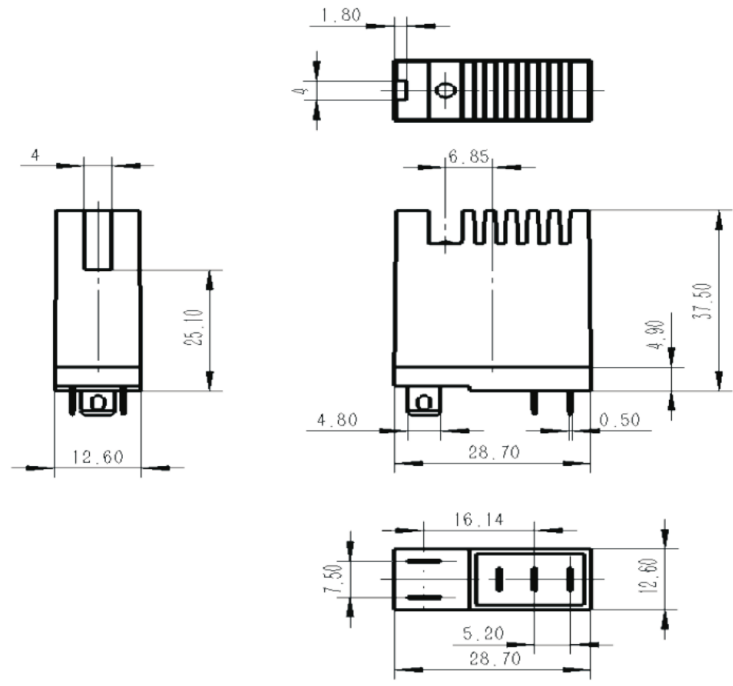
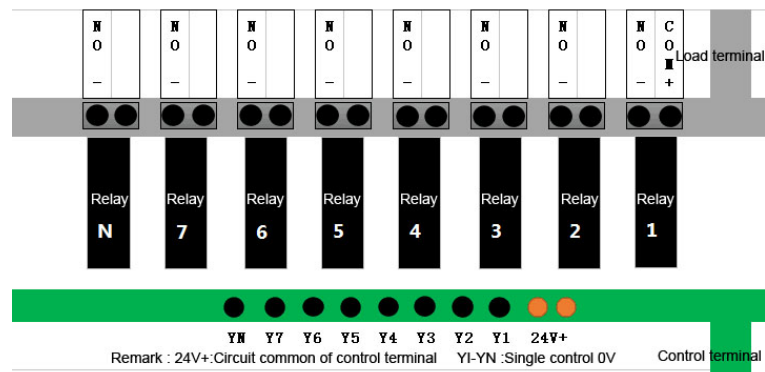
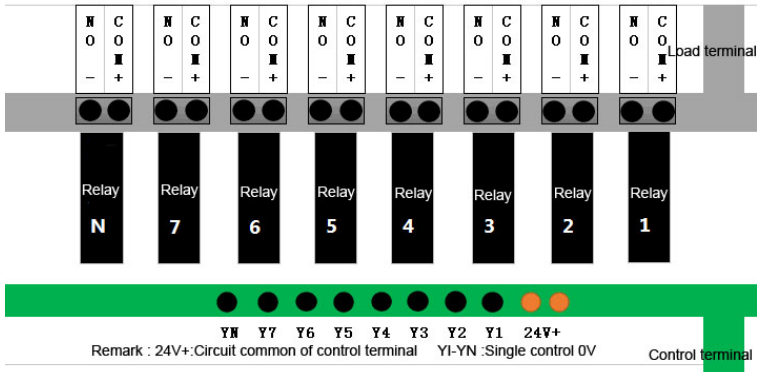

- Remark:
- 1)In case of no tolerance shown in outline dimension :
 Outline dimension 1mm ,tolerance should be $\pm 0.2\text{mm}$
 Outline dimension 1mm and 5mm ,tolerance should be $\pm 0.3\text{mm}$
 Outline dimension 5mm ,tolerance should be $\pm 0.4\text{mm}$
 - 2)The tolerance without indicating for PCB layout is always $\pm 0.1\text{mm}$